

INSTACLIC® INSTALLATION

InstaClic® is a revolutionary system for installing laminate floors without using glue. The panels can be clicked together simply; thanks to the ingenious shape of the tongue and groove. InstaClic® is unique because you can install the planks in two different ways:

Method 1

Position the panel to be installed at an angle of 20° to 30° to the panel already installed. Move the panel gently up and down and at the same time exert forward pressure. The panels will automatically click into place. You can either insert the tongue into the groove, or the groove on to the tongue. The tongue into groove method is the most common and easiest way.

See diagram 1A – 1B - 1C.

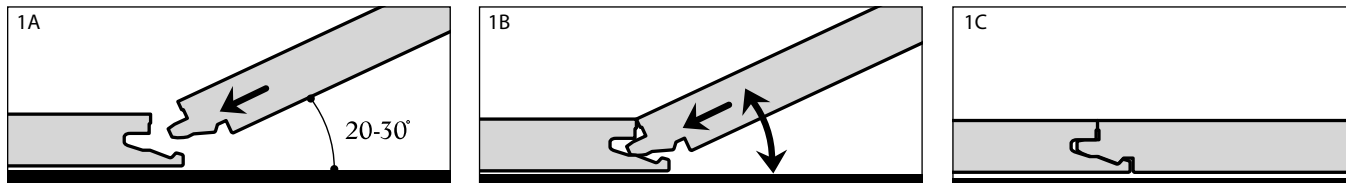

Method 2

With InstaClic® you can also tap the panels into each other without lifting. For this method you must use the special InstaClic® tapping block. The planks should not be joined with a single tap. To avoid damaging the panels you must tap them together gradually.

See diagram 2A - 2B.

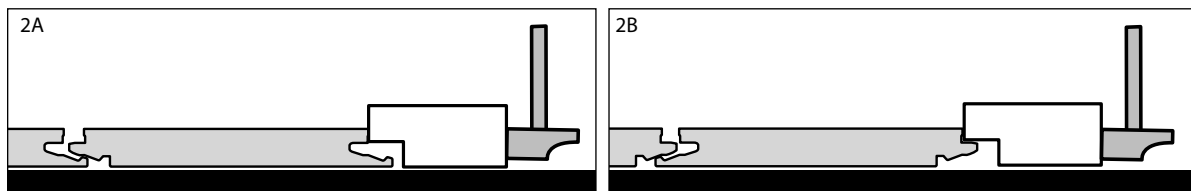

TOOLS FOR INSTALLING THE FLOOR

For best results, it is essential that you follow the installation instructions exactly. Besides the regular tools for installing laminate floors (i.e. hammer, saw, pencil, measure) you will also need the following accessories. Otherwise, the guarantee could be voided.

- ✓ Mohawk installation kit (crowbar, spacers (1-8 mm / 0.039”—0.315”) and InstaClic® tapping block). If you use any other type of tapping block, you will damage the panels.
- ✓ Mohawk underlayment system—SilentGuard™ or MoistureGuard™.
- ✓ Mohawk maintenance products—Mohawk Floorcare Essentials.

The use of accessories other than Mohawk accessories might cause damage to the Mohawk floor. In such case, the warranty provided by Mohawk will be void. We, therefore, advise the consumer to use only Mohawk accessories as these have been specially designed and tested for use with Mohawk floor panels.

Use a fine-toothed handsaw, a jigsaw, or a crosscut saw to cut the panels. To obtain a clean cut, the pattern side should face down when you use a jigsaw, sabre saw, or circular handsaw and up when you use a handsaw or a crosscut saw.

NINE FOCUS POINTS

1. Thanks to the InstaClic® system, the floor floats and is installed without glue. You can walk on the floor during and immediately after installation.
2. With InstaClic® panels you can choose where you want to begin. Think about what will be the easiest way to install the floor. We will demonstrate the installation for right-handed people, from left to right. You can work in the other direction if you want.
3. Make sure the panels are mixed sufficiently when you install them, so that you do not end up with too many identical, light or dark panels next to each other.
4. Check all panels in daylight before and during installation. Defective panels must never be used.
5. The floor should preferably be installed parallel to how the light enters the room. The ideal conditions are 59-68°F at a relative humidity of 50-60%.
6. For 7 mm thick planks, the planks **MUST** acclimate for 48 hours in the original, unopened packaging at the normal room temperature, in the middle of the room where the floor is to be installed. Be sure to put the cartons in the middle of the room, never against a wall or corner. Acclimation is not necessary for planks thicker than 7 mm.
7. Room humidity can vary according to the season, so it is vital that the floor is able to expand and contract. For this reason, make sure you leave an expansion joint of minimum 3/8” on all sides of the floor, around pipes, thresholds, and under doors.
8. Large rooms must have expansion joints every 40 feet width-wise to the panels and every 40 feet in all directions. It is recommended to provide an expansion joint between different rooms (e.g. under the door). Expansion joints can be covered using a T-molding that is attached to the subfloor.
9. Be sure to stagger end joints not less than 8”, so that no two end joints on successive rows are in line.

PREPARING THE ROOM

- ✓ Check that the doors can still open and close after the floor and underlayment have been installed (minimum + 3/8” [1 cm]).
- ✓ Check whether the old molding can be removed. You can also leave the wall base and finish the floor with Mohawk profiles.
- ✓ Make sure the subfloor is flat. Flatten any unevenness of more than 1/8” per 6 feet or 3/16” per 10 feet. It is vital that you use one of the Mohawk underlayments to smooth any unevenness in the base floor. The specially designed Mohawk SilentGuard™ and MoistureGuard™ underlayments have a damp-proof, insulating, noise-reducing and leveling function. The smooth top surface makes installing the laminate panels easier and ensures ample expansion afterwards. Please Note: You must use

Mohawk underlayments for the warranty to be completely valid. You can find more information about Mohawk underlayments and how to install them in Section 1.5.

- ✓ Make sure the subfloor is clean and dry.

CONCRETE SUBFLOOR

New Construction

- ✓ A new concrete floor must dry at least 90 days or 1 week per 3/8" thickness up to 1-1/2" thick. Thicknesses over 1-1/2" require twice as much drying time. For example, a 2-1/2" concrete subfloor must dry for at least 8 weeks. The moisture content must be less than 5 lbs./24 hrs./1000 sq. ft. (Calcium chloride method ASTM 1869).
- ✓ If there is underfloor heating, please consult Mohawk Technical Services at 1-888-387-9881.

Renovation

- ✓ Remove any damp-porous floor covering (carpet, needle felt, etc.) first.
- ✓ Damp-sealed floor covering (PVC, linoleum, VCT, etc.) does not have to be removed. Always use Mohawk underlayment.

Wooden Subfloor

- ✓ Remove any existing floor covering first.
- ✓ Make sure the plank floor is stable. Nail down any loose parts and apply a leveling layer Mohawk Softboard if necessary.
- ✓ Install the InstaClic® panels crosswise to the direction of the existing subfloor.
- ✓ It is essential that the crawl space under the plank floor is sufficiently ventilated. Remove any obstacles and provide sufficient ventilation equal to 1.5% of total square footage (ex. 1000 sq. ft. x 0.015 = 15 sq. ft. of total ventilation. If ventilation holes are .8333 sq. ft [15" x 8"] then you will need 18 ventilation holes. The moisture content of the wood may not exceed 10%.

INSTALLING THE FLOOR

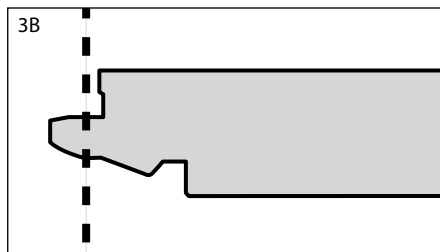
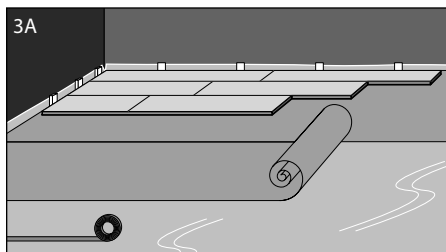

- ✓ First install the underlayment, per width and gradually as you progress. It is absolutely vital that you use Mohawk approved underlayments SilentGuard™ or MoistureGuard™ (200 ft. per roll). Let the membrane run up the wall a bit before cutting to

size. A molding will be attached to this later. See diagram 3A.

- ✓ Begin the first row with a whole plank. First saw off the tongue on both the long and the short sides. See diagram 3B.

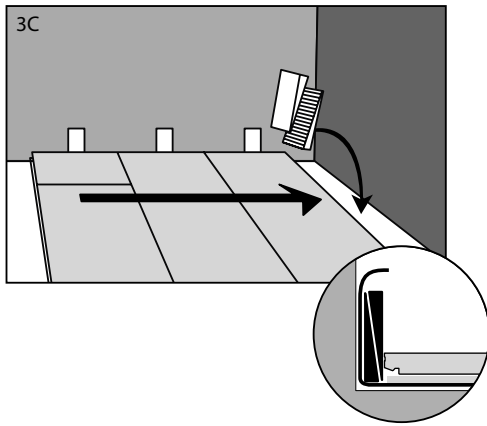

- ✓ Put the plank with sawn-off sides against the walls. Put spacers from the installation kit between the planks and the wall. This will ensure that your expansion joint is 3/8" wide.

The diagrams indicate where the InstaClic® panels are clicked together by moving up and down or where they are tapped together flat. Follow the diagrams precisely. See diagrams 4.1 through 4.16 on the following page.

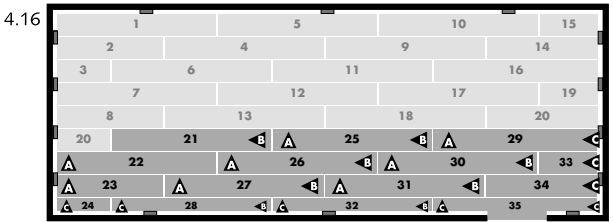
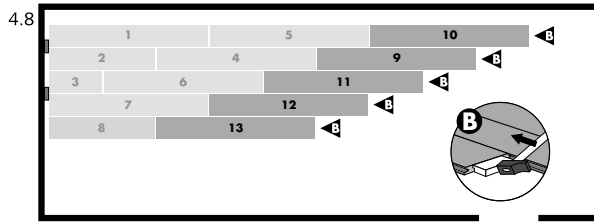
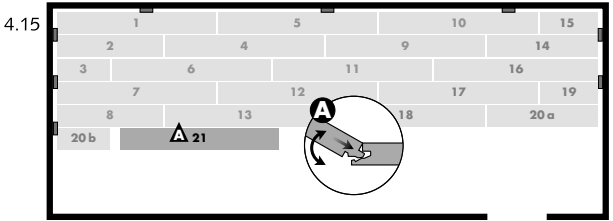
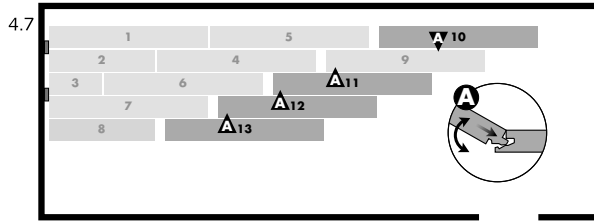
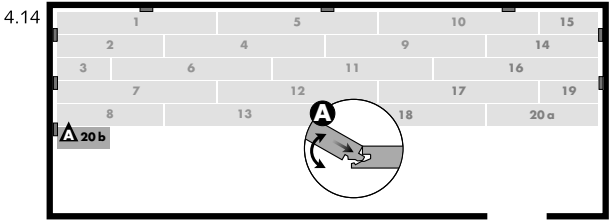
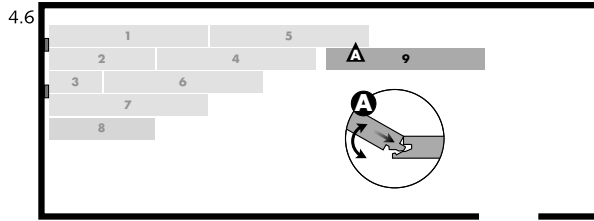
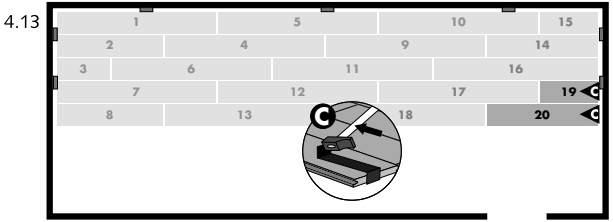
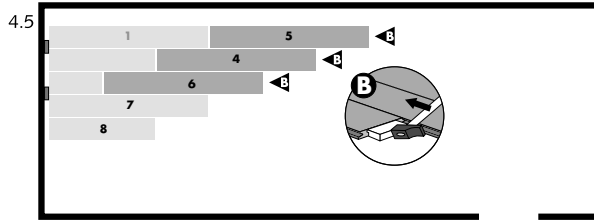
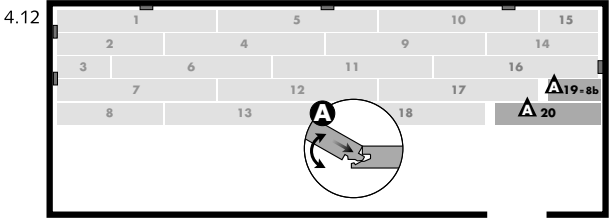
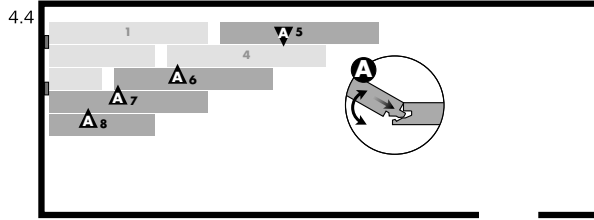
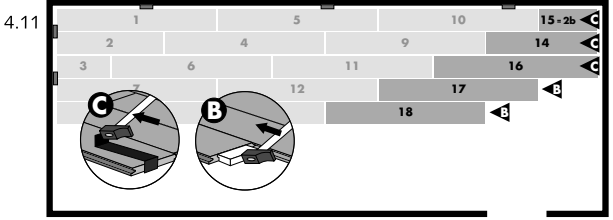
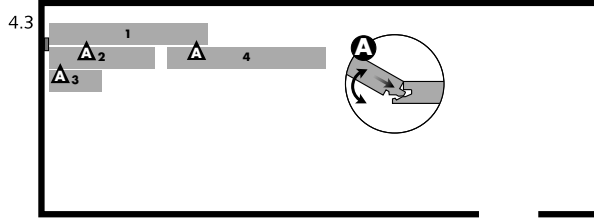
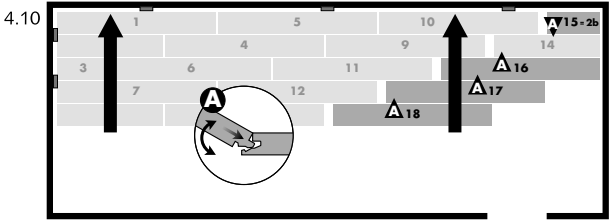
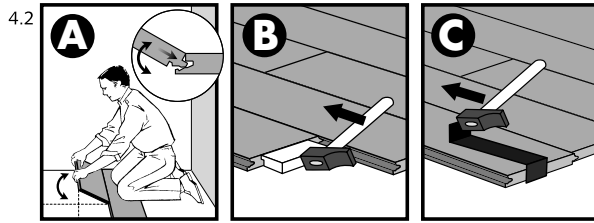
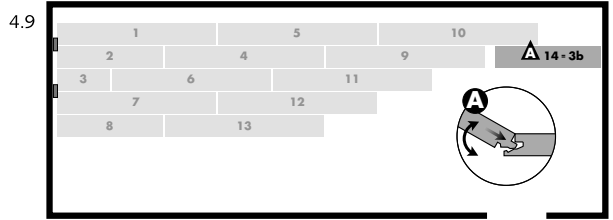
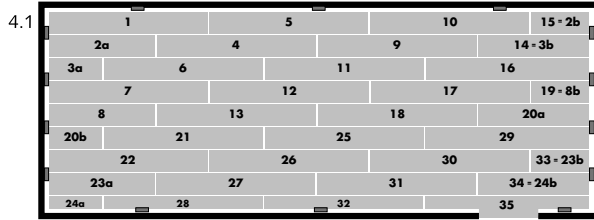

- ✓ In places where it is too difficult to install the InstaClic planks with the tapping block (e.g. against the wall), you can tap them together using the crowbar and a hammer. See diagrams 5A – 5B - 5C.

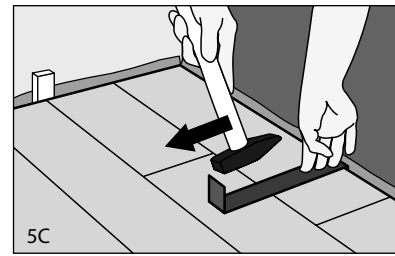
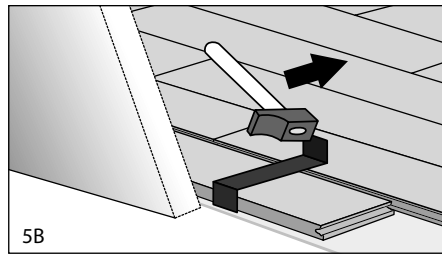
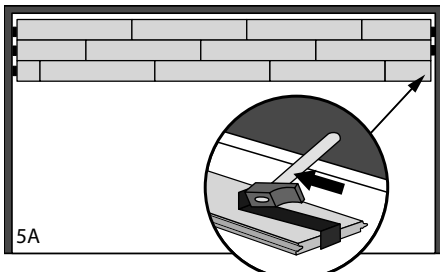

- ✓ There must also be a 3/8" expansion joint between the last row and the wall. Keep this in mind when sawing the last row of panels.

Pipes

In rows where there is a pipe, make sure the pipe falls exactly in line with the short side of two panels. Take a drill bit with the same diameter as the pipe plus 3/4" for the expansion. Click the panels together on the short side and drill a hole centered on the joint between the two panels. Now you can install the panels in the floor.

See diagrams 6A-6B-6C.

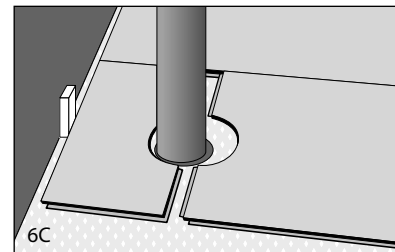
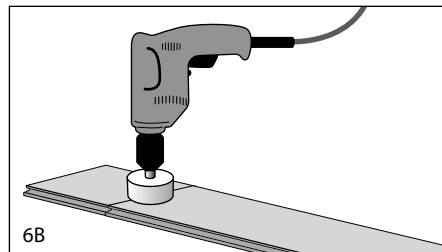
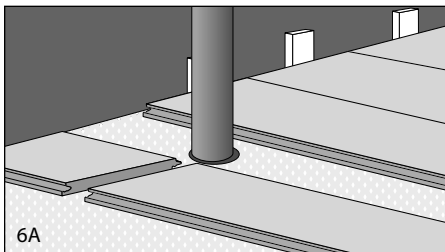

Under doorframes

When sawing the panels ensure that the expansion joint under the door is at least 3/8" (9 mm). If you cannot lift the panel, use a InstaClic® tapping block or crowbar and hammer to tap the panels together with the planks are flat on the floor.

See diagrams 7A-7B.

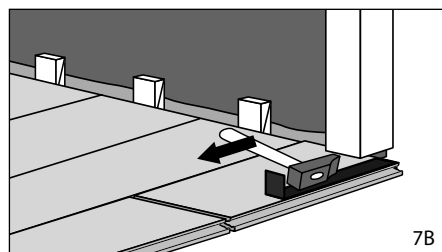
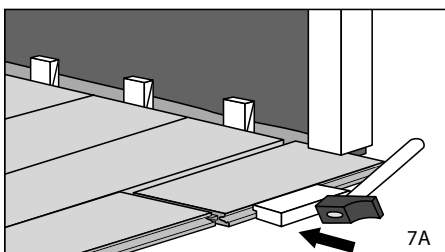

Finishing

- ✓ Remove all spacers.
- ✓ Install the molding on the plastic membrane that runs up the wall from under the floor. Never attach the molding to the floor. This method allows the floor to expand and contract under the molding.
- ✓ For a perfect finish around pipes, use rosettes or caulking.
- ✓ In places where profiles or skirting cannot be placed, fill expansion gaps with caulking. See diagram 8A.
- ✓ For installation of InstaClic® in wet areas such as kitchens, bathrooms, and laundry rooms, refer to Section 1.7.

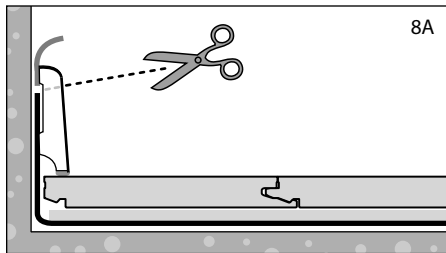

PRECAUTIONS

- ✓ Protect your floor by applying felt or plastic caps to feet of furniture and chairs.
- ✓ Avoid bringing dirt, water and sand indoors by providing a suitable floor mat at the door.
- ✓ Use (office) chairs and seats with soft wheels that are suitable for a laminate floor and/or use a suitable desk mat.
- ✓ Ensure that humidity in the room is always at least 50-60%. Use a humidifier if you need to.